

petainerKegs S pr - Instructions for use

Before filling, ensure that the filling head, the keg fitting and all pipes are clean and sterilized and purge the relevant inlet with inert gas and product. The keg must be in a stable and vertical position through the following process. Eye and ear protection, together with work-wear should be used.

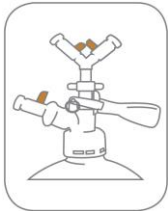

1. To Begin:

- Check that a petainerKeg filling head is used (see below).
- Push the filling head into the fitting.
- Hold the fitting with one hand and turn the filling head clockwise until it stops and push the handle down.
- Note: **Avoid pushing down the handle twice**, otherwise the automatic pressure relief valve will be activated and remain "open" after filling.



2. Inert gas purging:

- Open the "gas out" valve (3).
- Then slowly open the "gas in" valve (1) until completely open.
- Continue to purge for 30 s (recommended, should lead to <0,2% O₂ in the keg).
- Note: The pressure of the gas used should be within 1,5 and 2,5 bar / 22 and 36 psi.

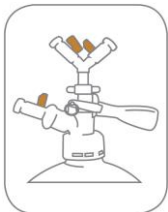

3. Counter pressurizing:

- Close the "gas out" valve (3) and wait for the keg to pressurize.
- Then close the "gas in" valve (1).
- Note: Ideally the keg should be pressurized at 0,5 bar / 7 psi below the filling pressure.

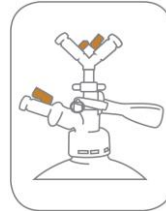

4. Filling:

- Ensure that the "gas in" valve (1) is closed.
- Open the "product in" valve (2) slowly to allow the product to flow into the keg.
- Control the filling speed and foaming throughout the fill by adjusting the "gas out" valve (3).
- Note: The filling pressure should not exceed 3,0 bar / 43.5 psi.
- If an accurate fill is required it is recommended filling the keg on a scale.

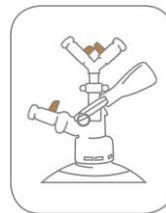

5. End of Filling:

- Once the keg is determined to be full either by weight or by level.
- Note: It is recommended to leave a headspace at the top the keg of at least 200ml / 8.5 fl oz.
- Close the "gas out" valve (3) followed by the "product in" valve (2), then lift up the handle.
- Turn the filling head counter clockwise and remove it.
- Clean/disinfect and dry the fitting.
- Put a snap-cap / dust-cap on the keg fitting and place the keg in the box.
- Note: If circumstances allow, use filling temperature above the dew point **or** acclimatize the kegs before placing into boxes **or** use waterproof boxes.

After Filling: Open all valves, clean the filling head with water and store it in disinfectant or under dry atmosphere.

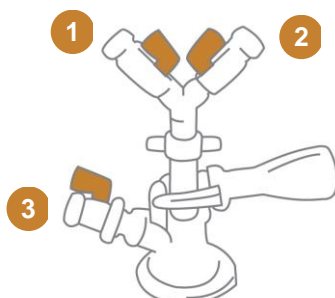

petainerKeg S-Type Filling Head (Article-number: A2210.33)

- 1 "gas in"
- 2 "product in"
- 3 "gas out"